



Pictured (Left)

Panel System (As Shown)
Total List: \$2645

Complete Package (As Shown w/Desks)
Total List: \$4259
 Includes: SP6624(2), SP6672(3), SPG6624(2), SPCAP66(4), SP266(2), SP366(2), PL192(2), PL182L, PL182R, PL166(2).

20-20
GIZA



OFFICESOURCE™
 PANEL SYSTEMS

PANEL SYSTEMS DETAIL

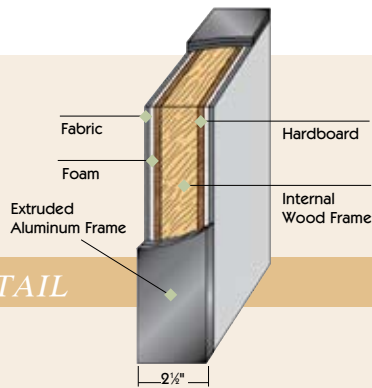

For Complete Listing of all PL Components See Page 43.

UPHOLSTERED PANELS

MODEL #	DIMENSION	LIST PRICE
SP4224	24"W x 42"H	\$175
SP4230	30"W x 42"H	\$193
SP4236	36"W x 42"H	\$223
SP6624	24"W x 66"H	\$218
SP6630	30"W x 66"H	\$243
SP6636	36"W x 66"H	\$265
SP6648	48"W x 66"H	\$310
SP6660	60"W x 66"H	\$355
SP6672	72"W x 66"H	\$445

OPAQUE VIEW-THROUGH PANELS

MODEL #	DIMENSION	LIST PRICE
SPG6624	24"W x 66"H	\$258
SPG6630	30"W x 66"H	\$288
SPG6636	36"W x 66"H	\$318

ACCESSORIES

MODEL #	DESCRIPTION	LIST PRICE
SP242	2 Way Corner connector 42"	\$40
SP266	2 Way Corner connector 66"	\$58
SP342	3 Way T connector 42"	\$50
SP366	3 Way T connector 66"	\$75
SP442	4 Way + connector 42"	\$50
SP466	4 Way + connector 66"	\$75
SPPG24	24" Filler For 42" to 66"	\$13
SPCAP24	End Cap 24"	\$15
SPCAP42	End Cap 42"	\$18
SPCAP66	End Cap 66"	\$23
SPBASE1	Support Foot	\$33
SPWM42	Wall Mount Kit 42"	\$45
SPWM66	Wall Mount Kit 66"	\$63
SPSH36	36"W Laminate Shelf (Charcoal)	\$80
SPSB2	Pair of Shelf Brackets	\$45
SPTB	Top Bracket for Stabilizing Straight run of Panels	\$8



Optional
Shelves

Fabric/Finish
Available:

Pewter/Charcoal



Pictured (Above)

Panel System (As Shown)
Total List: \$1756

Complete Package (As Shown w/Desks)
Total List: \$2563
 Includes: SP6624(2), SP6636(2), SP6672, SPCAP66(2), SP266(3), SPSH36, SPSB2, PL182R, PL192, PL166.